

challenge #5

gone fishing



To catch a fish, you need patience, determination, and skill. Of course, it would help if you also had a good fishing pole! A fishing pole is a simple machine with a reel to make it easier to pull in that prize-winning fish.

YOUR CHALLENGE :

Use Blueprint to design and build a working model of a fishing pole. Your build must meet the following requirements:

be at least 10 pitches long from the reel to the pole's tip (25 centimeters);

use a Hand Crank, pulley, and rope;

be able to reel in a 3x Pitch Weighted Truss "fish" (75 grams).

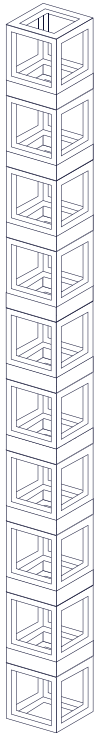

10 PITCH

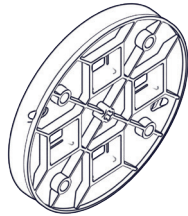

PULLEY

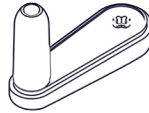

HAND CRANK

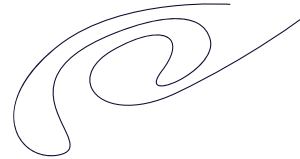

ROPE

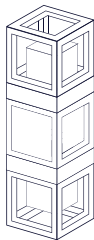

3x PITCH
WEIGHTED TRUSS



STUDENT HANDOUT
sphero.cc/bpc5sh